

# SANTA FE







# Wise and Wide Care

No matter what kind of day lies ahead of you, Santa Fe will always give you a great start. Whether you face your usual routine or a special occasion to surprise your family or a long-planned trip, Santa Fe will let you and your family move easily, comfortably and stylishly. Things are always better with Santa Fe, in all ways.





# Rediscovering happiness.

Every new detail in the new Santa Fe, both visible and hidden, is geared towards one goal: family. Rediscover your family's happiness with upscale designs that brighten up daily routines, interior spaces big enough to accommodate all types of lifestyles and advanced technology that keeps everyone safe at all times. Stay focused on your family's happiness. Santa Fe will do the rest.









# Making every day upscale.

Santa Fe's wide, distinctive grille merges seamlessly with the main headlamps while dynamic side proportions lead to the rear lamps, delicately wrapped around the edges of the vehicle. Santa Fe's perfectly-balanced stance will ensure an unrivaled presence on the road, helping you make every moment of your day brilliant.







# Making every day comfortable.

Santa Fe's interior isn't just bigger – it's filled with more thoughtfulness for the entire family. The high center console's soft and plush leather surface offers the comfort of an armchair the moment you sit down, while the neatly-aligned buttons allow hassle-free control of various functions. The state-of-the-art digital cluster and LCD screen are visually attractive to watch as they provide you with meticulous care while you drive.





A button-type gear shift lever is located conveniently on the center console, while video images of the vehicle's side rear blind spots can be seen on the cluster, making tricky lane changes safe and easy. Different drivers can also conveniently select previously-saved profiles for preferred GPS settings, air conditioning, radio and other features.

Bridge-type High Console & Shift-By-Wire Automatic Transmission



12.3" Full LCD Cluster & Blind-Spot View Monitor (BVM)



10.25" Display & Personal Profile / Wireless Smartphone Charging System





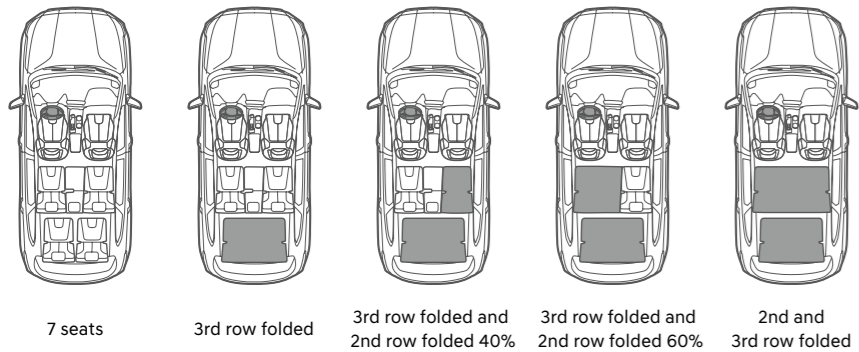

Don't worry about extra family members or distances with the Santa Fe. A wide choice of seat variations and convenient features will accommodate everyone, everywhere. A simple button is all it takes to fold and slide the second row seats forward for easier access to the third row seats, while Santa Fe's new platform and layout design provides more room in the second row and cargo area, ensuring a comfortable journey for all. When both hands are full, thoughtful details like the Smart Power Tailgate will take a load off your shoulders.

2nd and 3rd Row Seats & Space



One-Touch Walk-in & Folding / Smart Power Tailgate

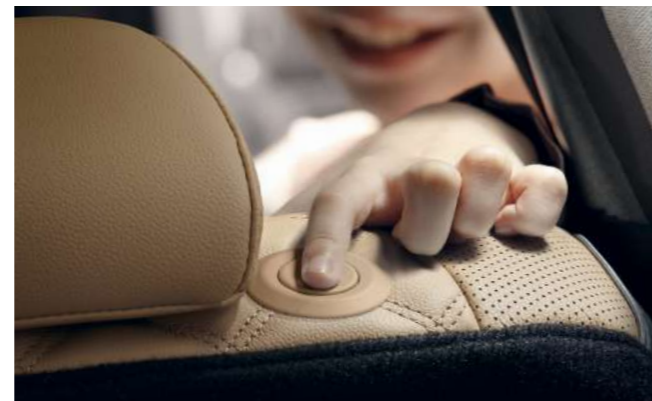









# Smart technology used wisely.

Simply adding a lot of technology to a car won't make it safer. Rather, Santa Fe is designed to smartly minimize the dangers in our everyday driving environment to ensure safety. So the next time you feel at ease backing out of a tight space or parking in a tricky spot, just know that Santa Fe's got your back.

#### Rear Cross-Traffic Collision-Avoidance Assist (RCCA)

This function warns the driver if a collision risk is detected from the left and right sides of the vehicle while reversing. If the risk increases even after the warning, RCCA helps to stop the vehicle.

#### Remote Smart Parking Assist (RSPA)

This enables the driver to control the forward/backward functions remotely from outside the vehicle via the key fob. Drivers can control the vehicle from outside the vehicle via the key fob to move forwards or backwards to enter/exit a parking space.



#### Surround View Monitor (SVM)

4 HD cameras mounted on the front, sides, and rear of the vehicle show the surroundings in real time.





Being prepared involves detailed and meticulous care. Santa Fe's Advanced Driver Assistance System considers the various conditions a driver might unexpectedly face to undertake complex decisions or minimize mistakes.

#### Smart Cruise Control (SCC)

This function maintains a speed set by the driver while keeping a set distance from cars in front. In the event of a full stop, the vehicle restarts automatically as long as the car in front departs within 3 seconds.



#### Lane Following Assist (LFA)

A front view camera detects the lanes on the road to help steer the vehicle and keep it centered inside the lane.

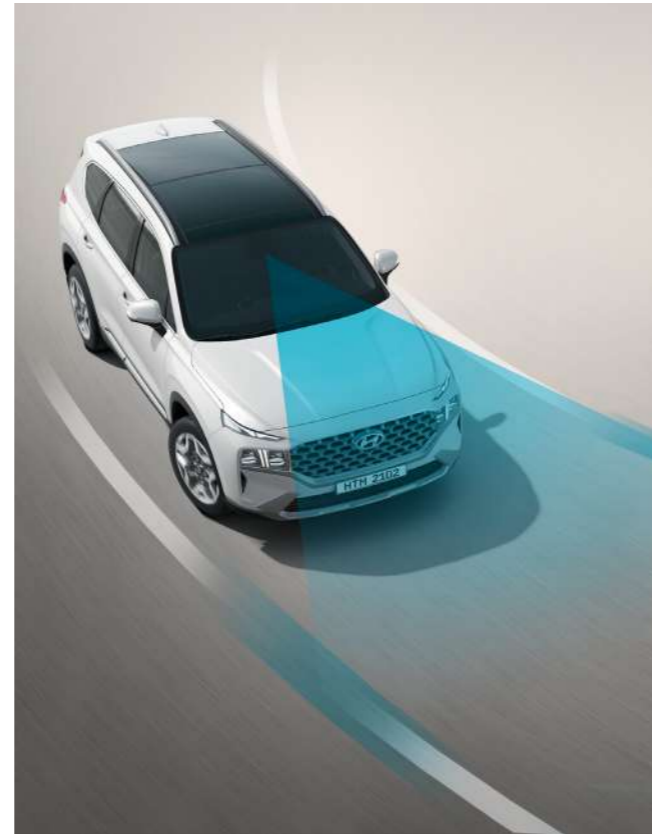

#### Forward Collision-Avoidance Assist (FCA, junction turning)

This function warns the driver when a forward collision risk is detected, such as with a pedestrian, cyclist or vehicle that suddenly slows down or stops ahead. If the risk of collision continues to increase after the warning, it automatically assists with emergency braking. The same applies to collision risks with oncoming vehicles while turning left at an intersection.



#### Blind-Spot Collision-Avoidance Assist (BCA)

When operating the turn signals to change lanes, if there is a risk of collision with a rear side vehicle, the function provides a warning. If the collision risk increases even after the warning, the function automatically controls the vehicle to help avoid a collision. If there is a risk of collision with a rear side vehicle while exiting a parallel parking spot, the function automatically assists with emergency braking.

#### Safe Exit Assist (SEA)

This function provides a warning if a vehicle approaching from the rear side is detected as the occupant opens the door to exit the vehicle. If you attempt to deactivate the child safety lock in such situations, SEA will override you to keep the rear doors closed.





# Diverse power options controlled easily.

Santa Fe's powerful driving performance boasts not only eye-catching numbers, but a wide range of options such as dynamic or comfortable driving, depending on the road conditions. Santa Fe also automatically recognizes the core driving tendencies of different family members, offering optimal driving modes for each driver.

## 2.5 MPI Gasoline Engine

180 Maximum Power  
ps/6,000 rpm

23.7 Maximum Torque  
kg-m/4,000 rpm

## 3.5 MPI Gasoline Engine

272 Maximum Power  
ps/6,400 rpm

33.8 Maximum Torque  
kg-m/5,000 rpm

## 2.2 CRDi Diesel Engine

202 Maximum Power  
ps/3,800 rpm

45.0 Maximum Torque  
kg-m/1,750-2,750 rpm

### Drive Mode

Simply turn knob to select the mode that suits you best: COMFORT for everyday driving, ECO for optimal fuel efficiency, SPORT for quicker acceleration, or SMART which automatically adjusts gear shift intervals based on recent driving patterns.

### Multi Terrain Control

When the going gets tough, Snow, Mud and Sand modes assure optimal tire traction over different types of rough terrain. A quick glance at the center cluster or AVN will confirm terrain mode status.







Equipped with diverse driving capabilities and a new platform that provides a spacious interior, the new Santa Fe's power and flexibility make it a family SUV ready for any situation. Features such as its AWD system, which optimally distributes power to the front and rear wheels depending on the driving conditions, and enhanced cargo space and leg room in the second and third rows will ensure a comfortable ride for any journey.

**HTRAC All-Wheel Drive**

This system automatically senses slippery or unstable driving conditions that even the driver may not detect and proactively balances power between the front and rear wheels to ensure stability at all times.

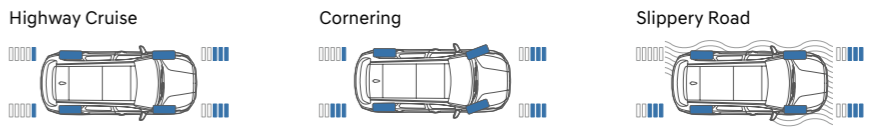

**New Body Platform**

A new, next-generation platform has been applied to the Santa Fe, maximizing vehicle stability and creating more cargo space and legroom in the second and third rows. The new platform also brings with it significant improvements in collision safety, thanks to the increased usage of Advanced High-Strength Steel and hot stamping.

2nd Row Leg Room (5seats / 7seats)	3rd Row Leg Room	Cargo Capacity (7seats, 3rd row folded)
1,060 / 1,040mm	746mm	max 782ℓ





# Happiness made easy.

Some things can't wait, like special moments with your family. Don't wait for another day to share today's happiness. Santa Fe's wide spaces, top-class safety and calm technology will capture every moment, perfectly.





# Features



LED Headlamps



Full LED Projection headlamp



Rear Combination Lamps



LED Rear Combination Lamps



LED Outside Mirror Repeaters



Radiator Grille



Safety Power Window



Beltline Molding

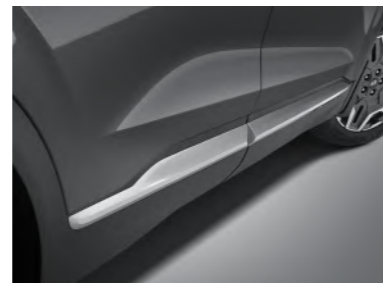

Side Garnish



Panorama Sunroof



Head-Up Display (HUD)



Rear Occupant Alert



Driver Attention Warning (DAW)



4.2" TFT LCD Cluster



Full Auto Air Conditioning System



17" Alloy Wheels



18" Alloy Wheels



19" Alloy Wheels



8" Display



10.25" Display



Harman Kardon Speaker



Front Seat Warming & Cooling Air Ventilation



Rear Door Manual Curtain



# Interior colors



Black One-tone Interior



Dark Beige Two-tone Interior



Cognac Two-tone Interior



Camel Two-tone Interior

# Exterior colors

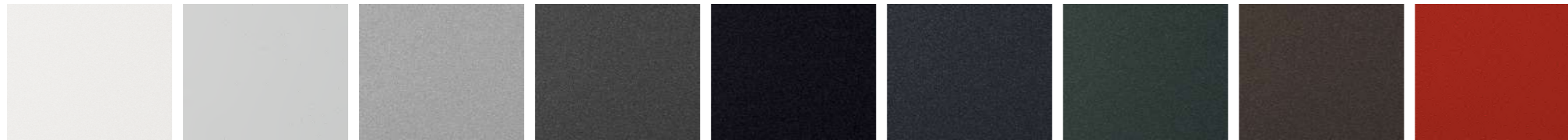

White Cream (WW2)    Glacier White (W3A)    Typhoon Silver (T2X)    Magnetic Forest (M2F)    Phantom Black (NKA)    Lagoon Blue (UE3)    Rain Forest (R2F)    Taiga Brown (RN7)    Lava Orange (YR2)

# Specifications

Type	2.5 MPI Gasoline Engine	3.5 MPI Gasoline Engine	2.2 CRDi Diesel Engine
Engine type	In Line 4 - Cylinders	V type 4 - Cylinders	In Line 6 - Cylinders
Displacement (cc)	2,497	3,470	2,151
Max. Power (ps / rpm)	180 / 6,000	272 / 6,400	202 / 3,800
Max. Torque (kg·m / rpm)	23.7 / 4,000	33.8 / 5,000	45.0 / 1,750 ~ 2,750
<b>Brakes</b>			
Front		17" (Φ325x30t)	
Rear	with ABS	16" (Φ305x11t)	
<b>Suspension</b>			
Front		McPherson Strut Type	
Rear		Multi-Link Type	
<b>Tire</b>			
		235/65 R17, 235/60 R18, 235/55 R19	

Dimensions			
Head Room (mm)	1st row (w/Sunroof) / 2nd row (w/Sunroof) / 3rd row		1,016 (974) / 990 (958) / 917
Leg Room (mm)	1st row / 2nd row (5 Seats) / 3rd row		1,052 / 1,040 (1,060) / 746
Shoulder Room (mm)	1st row / 2nd row (w/Curtain) / 3rd row		1,500 / 1,480 (1,450) / 1,344

- The above values are results from internal testing and are subject to change after validation.
- Some of the equipment illustrated or described in this catalog may not be supplied as standard equipment and may be available at extra cost.
- Hyundai Motor Company reserves the right to change specifications and equipment without prior notice.
- The color plates shown may vary slightly from the actual colors due to the limitations of the printing process.
- Please consult your dealer for full information and availability on colors and trims.



Overall Width 1,900  
Wheel Tread 1,646



Overall Length 4,785  
Wheel Base 2,765

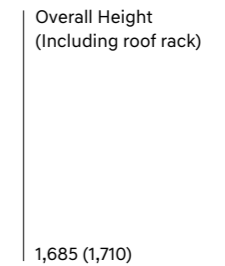

Overall Height (Including roof rack) 1,685 (1,710)



Wheel Tread 1,656

Unit : mm



Dealer stamp